

Effective Dimensioning and Efficient Layout of Compound Joinery

For Timber Frame Designers and Layout Personnel

TFG Conference, Thursday, Oct. 13, 2005, Burlington, Vermont
Instructors: Wil Dancy and Tony Wall of Dietrich's NA

A roof system containing complex compound joinery is a challenge from start to finish. How can we communicate the details of the structure, with the least amount of confusion and errors, especially when more than one person is involved?

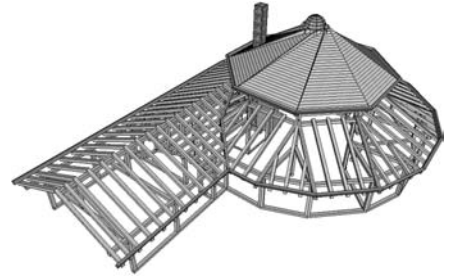

Through the analysis of many examples of compound joinery, participants will have the opportunity to experience two equally important perspectives. The first is the point of view of the designer, who in this case will also be the person responsible for dimensioning the shop drawings. We will encourage lively discussion regarding what needs to be dimensioned – or not!

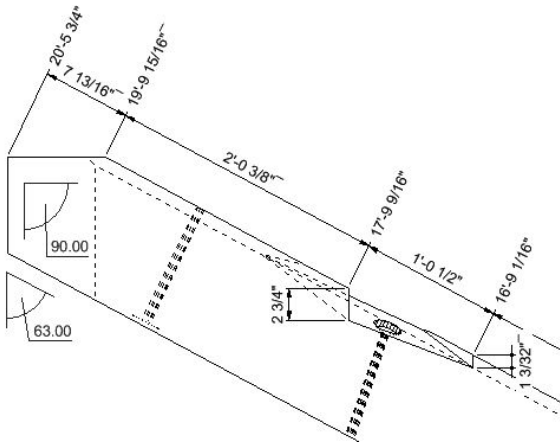

The second is through the eyes of the layout person, who has to make sense of the information that is provided by the designer. Hands-on layout of timbers will demonstrate the importance of understanding how to dimension compound joinery.

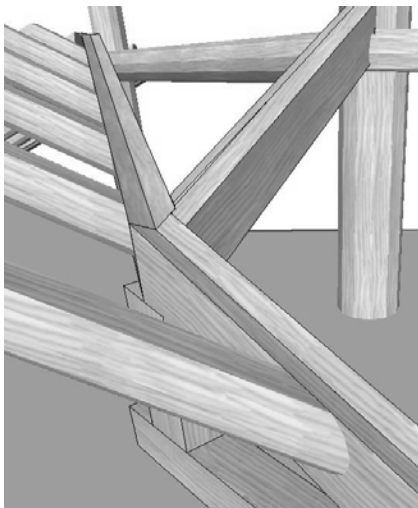

It doesn't matter whether the designer is drawing by hand or using CAD/CAM software; or whether the production team is using a chisel or a power tool. What does matter is that each person in this workshop will experience both perspectives. The goal isn't therapy for the workplace, although that would be a bonus! The goal is effective communication of the design details for efficient and accurate layout in the shop.